

## Spur gear winch TL300-600



# Spur gear winch

#### Product specifications:

- robust and safe hoisting winch
- static safety factor 4
- load pressure brake with double ratchet system
- maintenance free bearings
- adjustable crank with ergonomic grip
- cable outlet upwards
- in compliance with EN13157, DIN 15020 and EX types ATEX 114 (94/9/EG)
- paint thickness is 60 - 80 micron in 1 layer and in compliance with DIN/ISO 12944, C1M

#### Options:

- zinc-plated finish (6 - 8 micron)
- ATEX certified  II 3 GD T3, zone 2 and 22

#### Accessories:

- steel or stainless steel wire ropes
- pulley blocks suitable for hand winches



**GEBUWIN**  
metal products

Industrieweg 6, 7102 DZ Winterswijk, The Netherlands  
Telephone: +31(0)543 532600 Email: [info@gebuwin.com](mailto:info@gebuwin.com)  
For more information: [www.gebuwin.com](http://www.gebuwin.com)



## Technical specifications TL300-600

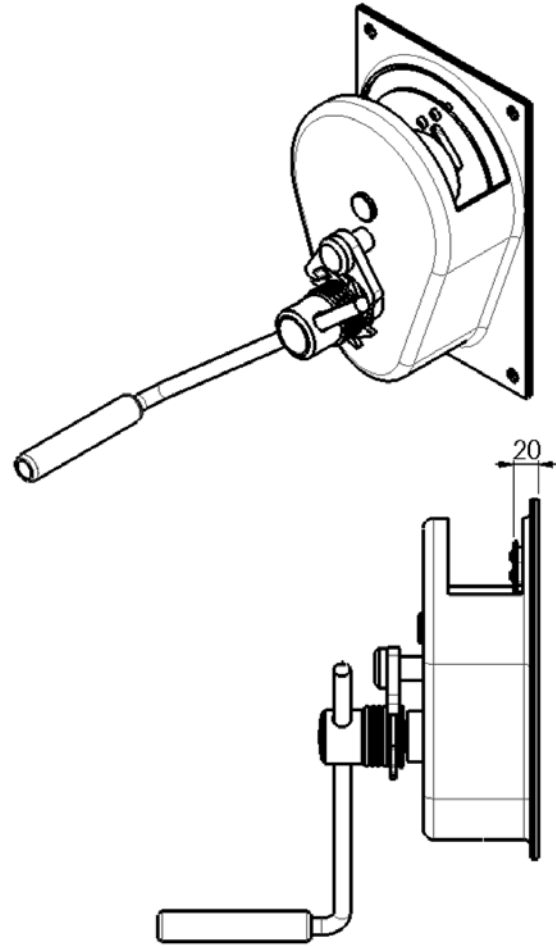
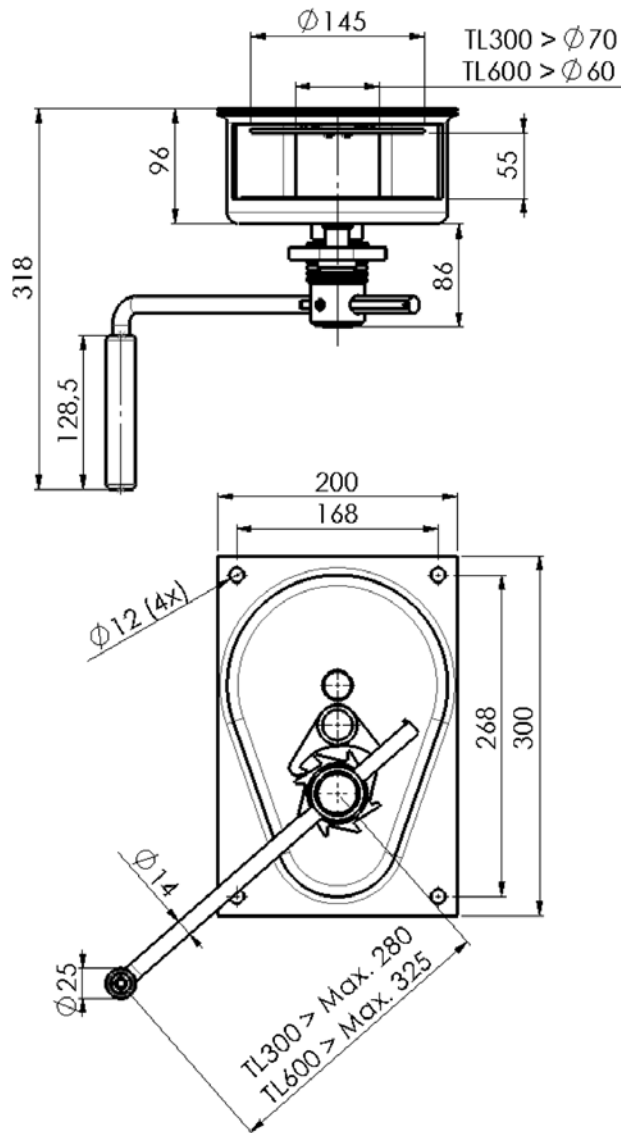

Type	Mounting	Material finish	Remarks
TL300 - 600 GR	Wall, 4x M8 class 8.8	Painted finish	RAL 7035 (grey)
TL300 - 600 EV	Wall, 4x M8 class 8.8	Zinc-plated finish	

Technical specifications		TL300	TL600
Capacity 1st cable layer	kg	300	600
Capacity last cable layer	kg	172	336
Crankforce 1st cable layer	daN	6	10
Hoisting length one rotation, 1st layer	mm	32	28
Max. cable storage (one cable drum)	m	35	12
Diameter cable	mm	4	6
Min. breaking load cable	kN	9	18
Own weight	kg	10	11

subject to changes

Form more information: [www.gebuwin.com](http://www.gebuwin.com)